

/ Descriptions

TO-126F PNP

/ Features

2SC3422

/ Applications

/ Equivalent Circuit

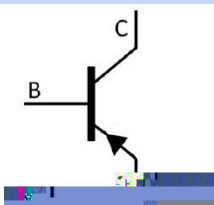

/ Pinning

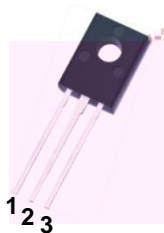

/ h_{FE} Classifications & Marking

/ Absolute Maximum Ratings(Ta=25)

/ Electrical Characteristics(Ta=25)

					μ

μ

/ Electrical Characteristic Curve

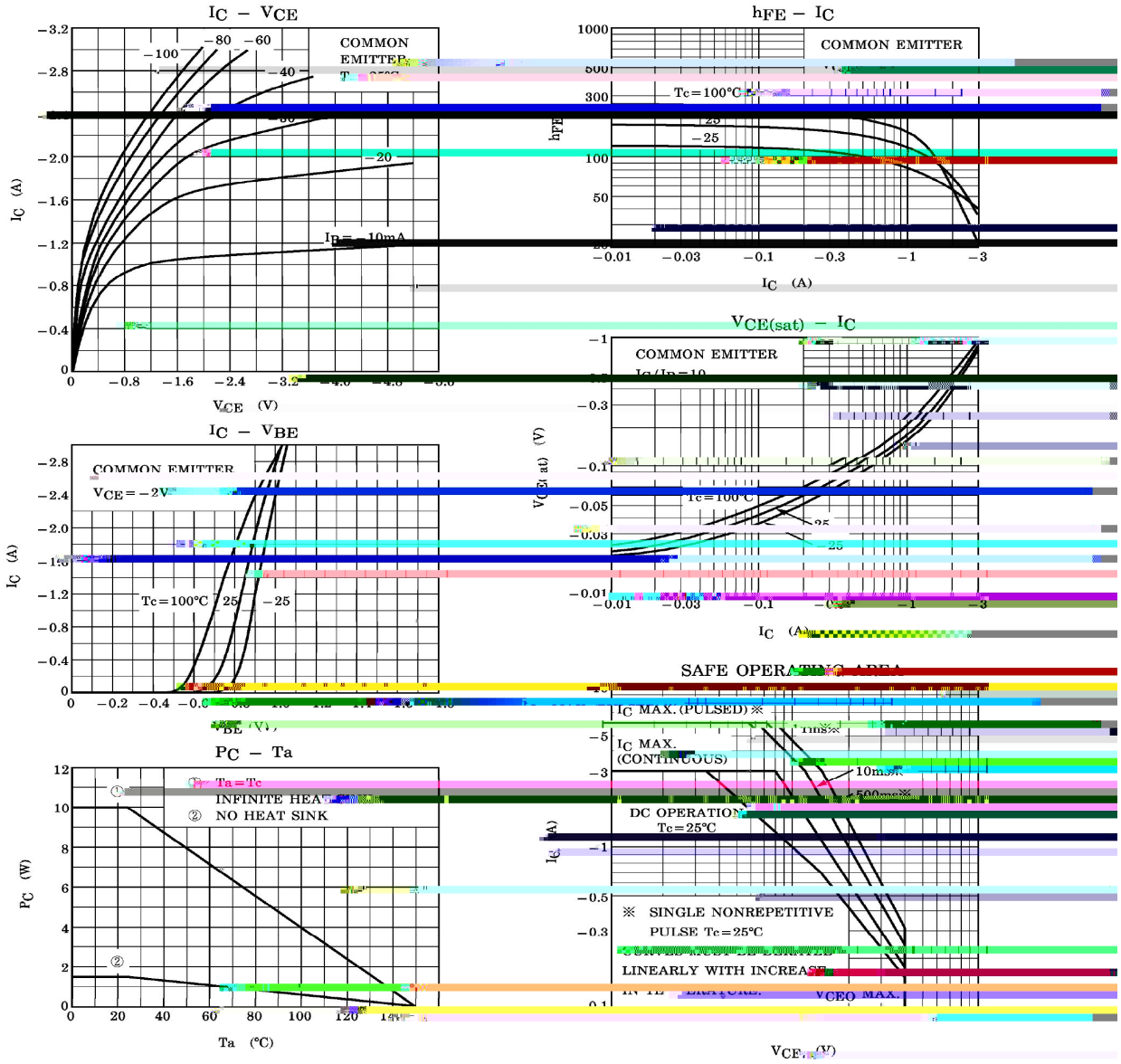

/ Package Dimensions



单位: mm

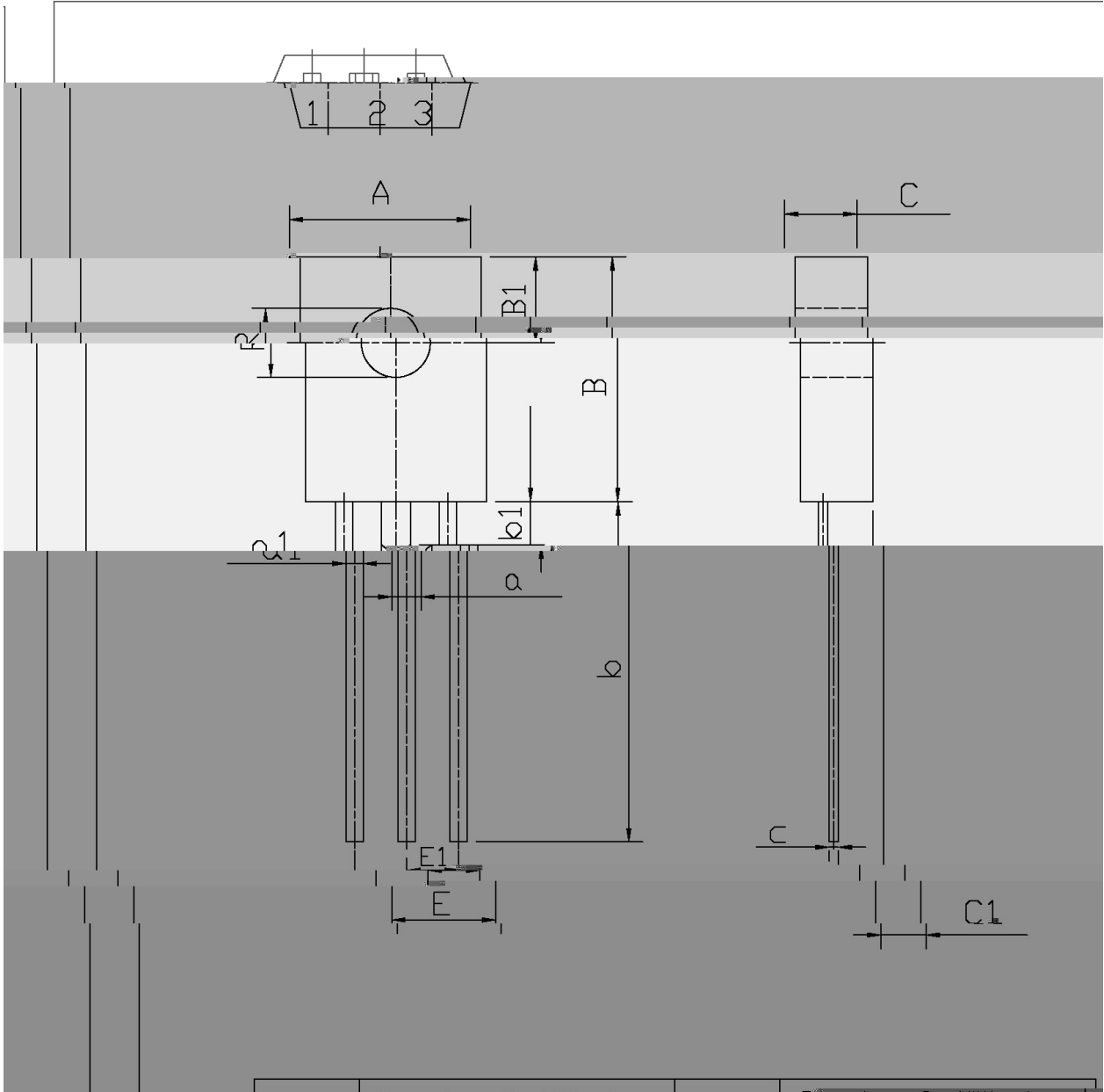

Symbol	Min	Max	Symbol	Min	Max
A	7.8	8.2	a	0.66	0.66
B	10.9	11.3	b	0.66	0.66
C	1.0	1.0	b1	0.66	0.66
B1	10.9	11.3	r	0.1	0.1
E	7.8	8.2	r1	0.1	0.1
E1	1.0	1.0			
C1	1.0	1.0			

() / Temperature Profile for Dip Soldering(Pb-Free)

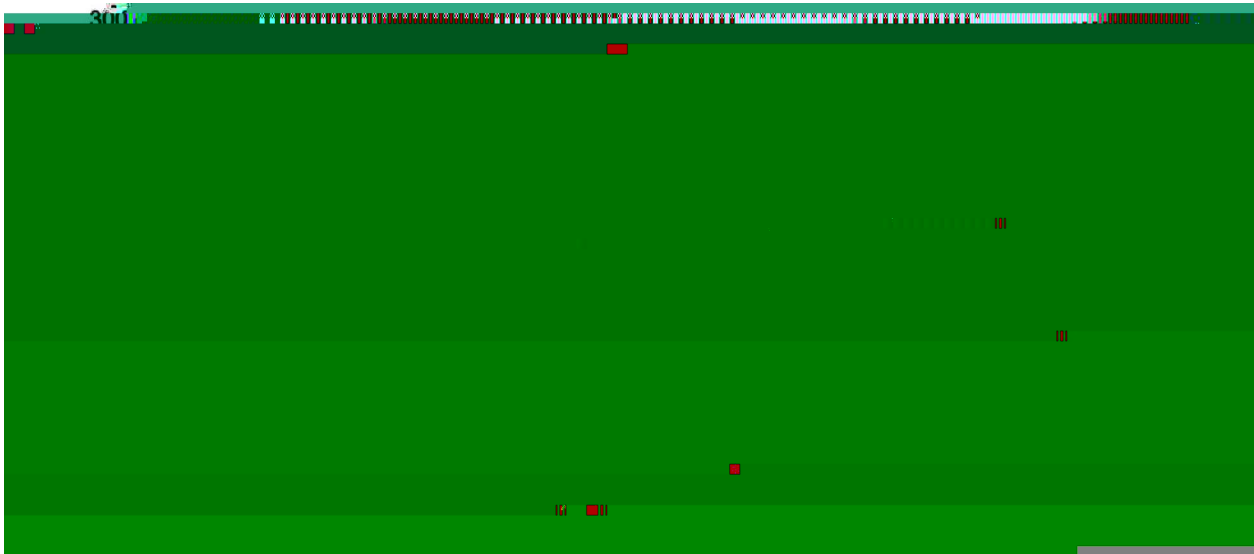

±

±

±

±

±

