

KF β - = E GE Silicon NPN transistor in a TO-126F Plastic Package.

High V_{CE0} , high f_T .

) . D ? q: 9
27MHz CB transceiver driver applications.

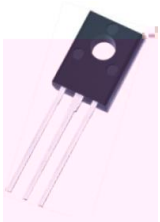

PIN1 Emitter PIN 2 Collector PIN 3 Base

/ h

Parameter	Symbol	Rating	Unit
Collector to Base Voltage	V_{CBO}	75	V
Collector to Emitter Voltage	V_{CER}	75	V
Collector to Emitter Voltage	V_{CEO}	45	V
Emitter to Base Voltage	V_{EBO}	5.0	V
Collector Current - Continuous	I_C	1.0	A
Collector Current – Continuous(Pulse)	I_{CP}	1.5	A

0em

/ Electrical Characteristic Curve

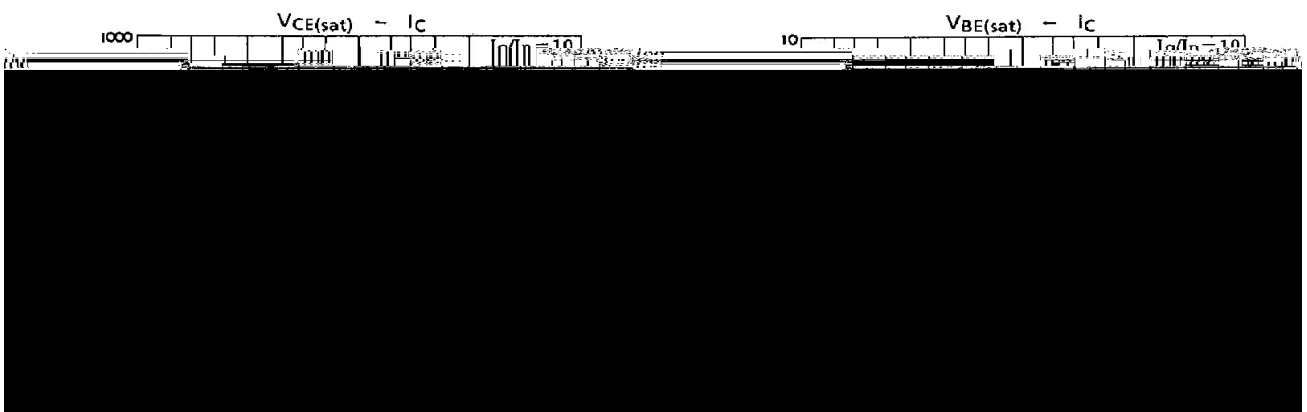
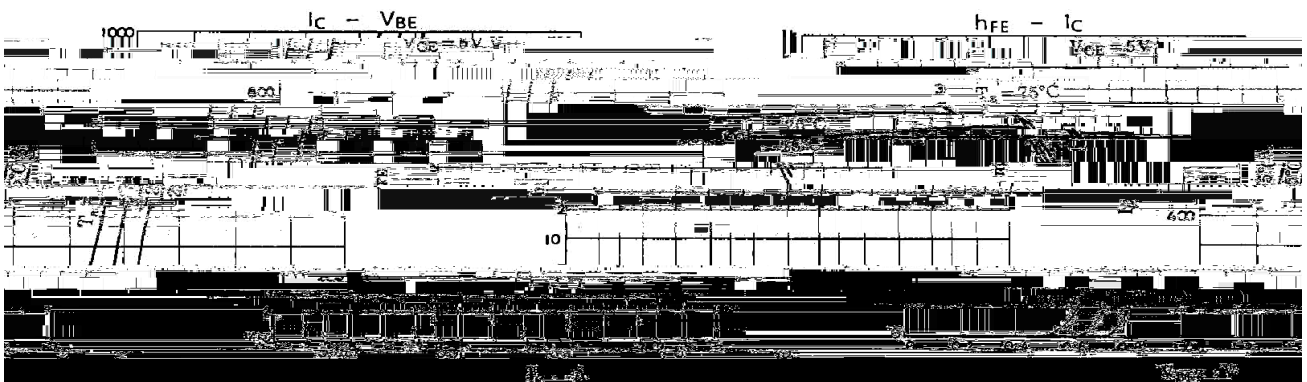
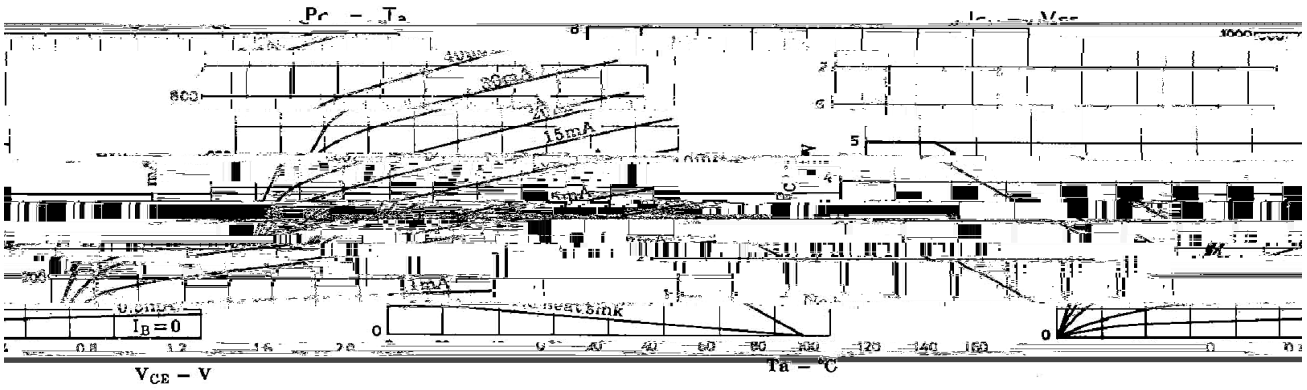

/ Package Dimensions

TU-126F

单位: mm

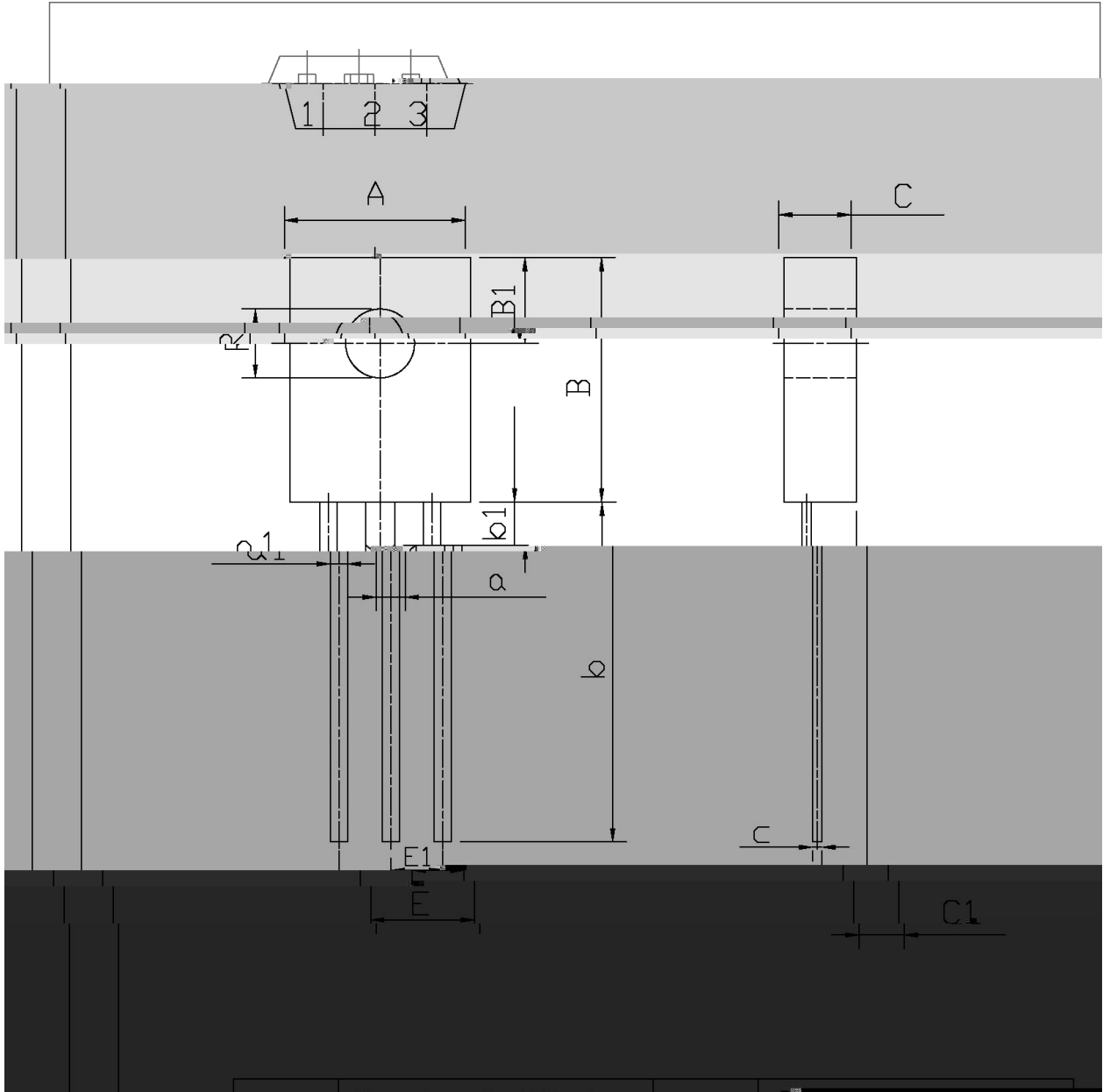

Symbol	Min	Max	Symbol	Min	Max
A	7.8	8.2	a1	0.66	

/ Marking Instructions



9|
:) * (+

