

2SC3063
Rev.E Mar.-2016

KF \$() - = E GE Silicon NPN transistor in a TO-126F Plastic Package.

High V_{CEO}

/ Absolute Maximum Ratings(Ta=25)

| Parameter | Symbol | Rating | Unit |
|---------------------------------------|-----------|---------|------|
| Collector to Base Voltage | V_{CBO} | 300 | V |
| Collector to Emitter Voltage | V_{CEO} | 300 | V |
| Emitter to Base Voltage | V_{EBO} | 7.0 | V |
| Collector Current - Continuous | I_C | 100 | mA |
| Collector Current – Continuous(Pulse) | I_{CP} | 200 | mA |
| Collector Power Dissipation | P_C | 1.2 | W |
| Junction Temperature | T_j | 150 | |
| Storage Temperature Range | T_{stg} | -55 150 | |

| Parameter | Symbol | Test Conditions | Min | Typ | Max | Unit |
|---|---------------|------------------------------------|-----|-----|-----|------|
| Collector to Base Breakdown Voltage | V_{CBO} | $I_C=10\mu A$ $I_E=0$ | 300 | | | V |
| Collector to Emitter Breakdown Voltage | V_{CEO} | $I_C=0.1mA$ $I_B=0$ | 300 | | | V |
| Emitter to Base Breakdown Voltage | V_{EBO} | $I_E=10\mu A$ $I_C=0$ | 7.0 | | | V |
| DC Current Gain | h_{FE} | $V_{CE}=50V$ $I_C=5.0mA$ | 50 | | 250 | |
| Collector to Emitter Saturation Voltage | $V_{CE(sat)}$ | $I_C=30mA$ $I_B=3.0mA$ | | | 1.5 | V |
| Base to Emitter Voltage | V_{BE} | $V_{CE}=10V$ $I_C=30mA$ | | | 1.2 | V |
| Transition Frequency | f_T | $V_{CB}=30V$ $I_C=20mA$ | 70 | 140 | | MHz |
| Collector Output Capacitance | C_{ob} | $V_{CB}=30V$ $I_E=0$ $f=1.0MHz$ | | 2.4 | | pF |

2SC3063
Rev.E Mar.-2016

/ Package Dimensions

TU-126F

单位: mm

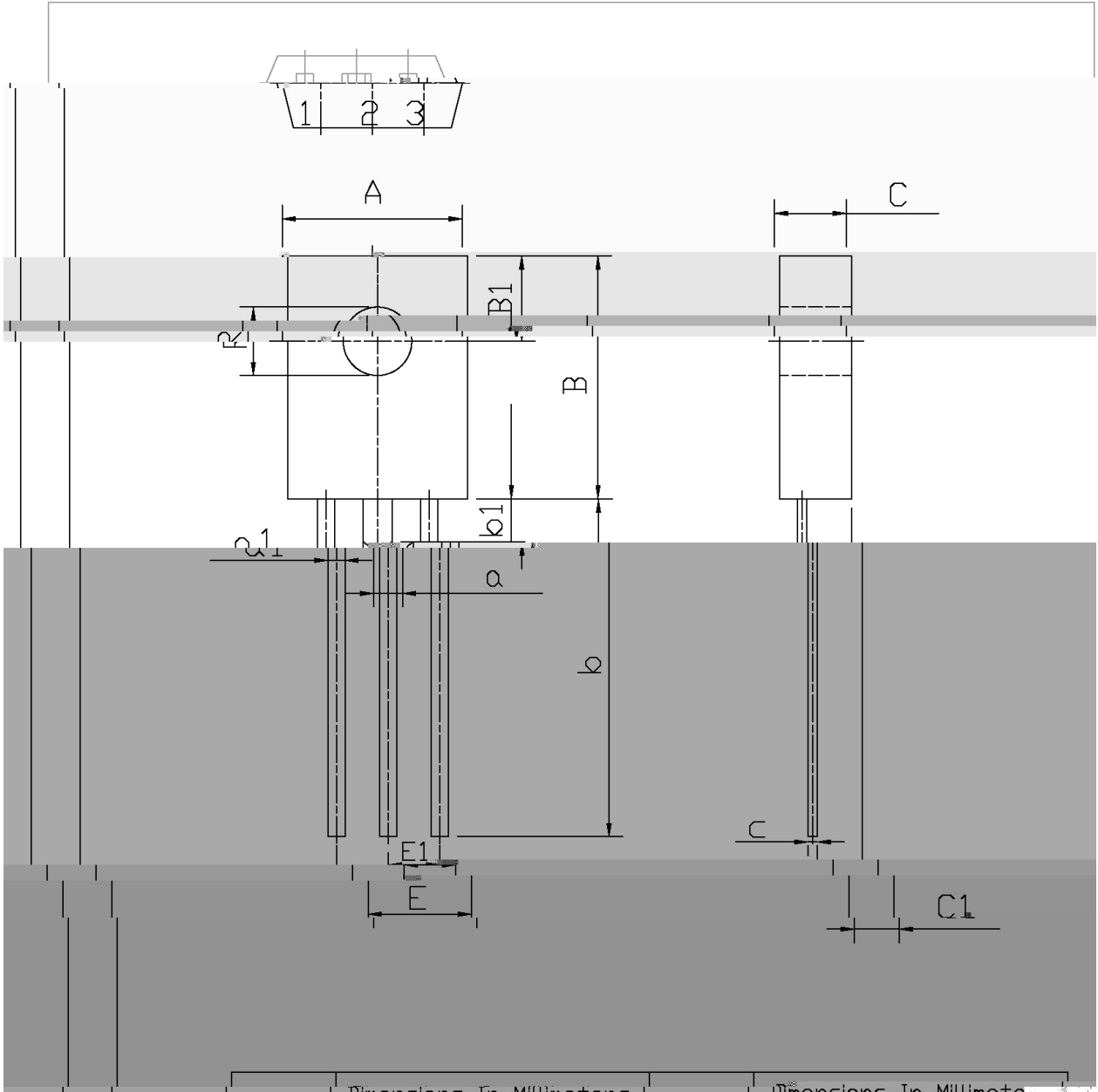

| Symbol | Min | Max | Symbol | Min | Max |
|--------|------|------|--------|------|-----|
| A | 7.8 | 8.2 | a1 | 0.65 | |
| B | 10.8 | 11.2 | E | 11.2 | |

/ Marking Instructions

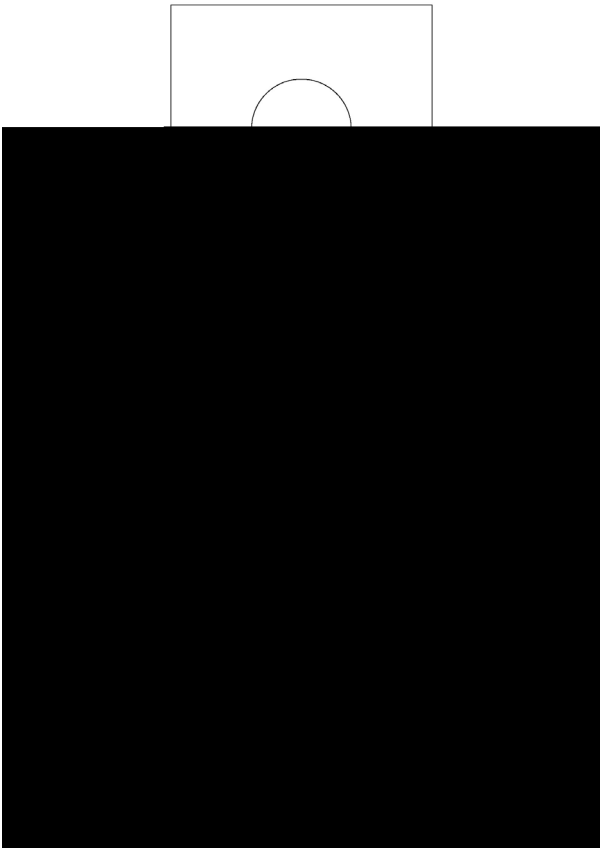

9|
: *! _ *
!!!!
Note:
BR: Company Code
C3063: Product Type.
****: Lot No. Code, code change with Lot No.

() / Temperature Profile for Dip Soldering(Pb-Free)

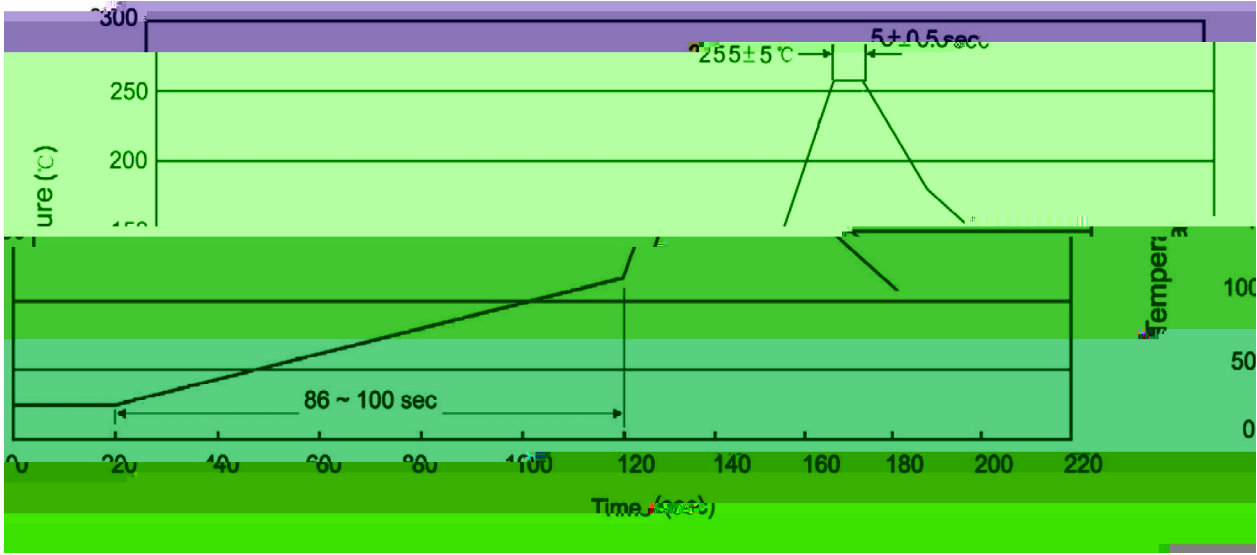

Note:

- | | | | | | |
|---|--------|-----|------------|--------|---|
| 1 | 25 | 150 | 60 | 90sec; | 1.Preheating:25~150 , Time:60~90sec. |
| 2 | 255..5 | | 5..0.5sec; | | 2.Peak Temp.:255..5 , Duration:5..0.5sec. |
| 3 | | | 2-10 /sec | | 3. Cooling Speed: 2~10 /sec. |

P8358SPEC. (Cooling