

# BF423

Rev.E Mar.-2016

## / Descriptions

TO-92

PNP

Silicon PNP transistor in a TO-92 Plastic Package.

BF422

High breakdown voltage, complementary pair with BF422.

High voltage switching and amplifier ,color TV chrome output.

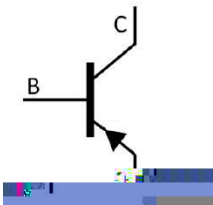

PIN1 Base

PIN 2 Collector

PIN 3 Emitter

## / hFE Classifications & Marking

See Marking Instructions.

Parameter	Symbol	Rating	Unit
Collector to Base Voltage	$V_{CBO}$	-250	V
Collector to Emitter Voltage	$V_{CEO}$	-250	V
Emitter to Base Voltage	$V_{EBO}$	-5.0	V
Collector Current - Continuous	$I_C$	-50	mA
Peak Collector Current	$I_{CM}$	-100	mA
Collector Power Dissipation	$P_C$	830	mW
Base Current - Continuous	$I_B$	-50	mA
Junction Temperature	$T_j$	150	
Storage Temperature Range	$T_{stg}$	-55 150	

Parameter	Symbol	Test Conditions	Min	Typ	Max	Unit
Collector Cut-Off Current	$I_{CBO}$	$V_{CB}=-200V$ $I_E=0$			-0.01	$\mu A$
Emitter Cut-Off Current	$I_{EBO}$	$V_{EB}=-5.0V$ $I_C=0$			-0.05	$\mu A$
DC Current Gain	$h_{FE}$	$V_{CE}=-20V$ $I_C=-25mA$	50			
Collector-Emitter Saturation Voltage	$V_{CE(sat)}$	$I_C=-30mA$ $I_B=-5.0mA$			-0.6	V
Base -Emitter Voltage	$V_{BE}$	$V_{CE}=-20V$ $I_C=-25mA$		-0.75		V
Transition Frequency	$f_T$	$V_{CE}=-10V$ $I_C=-10mA$	60			MHz
Reverse Transfer Capacitance	$C_{re}$					

/ Electrical Characteristic Curve

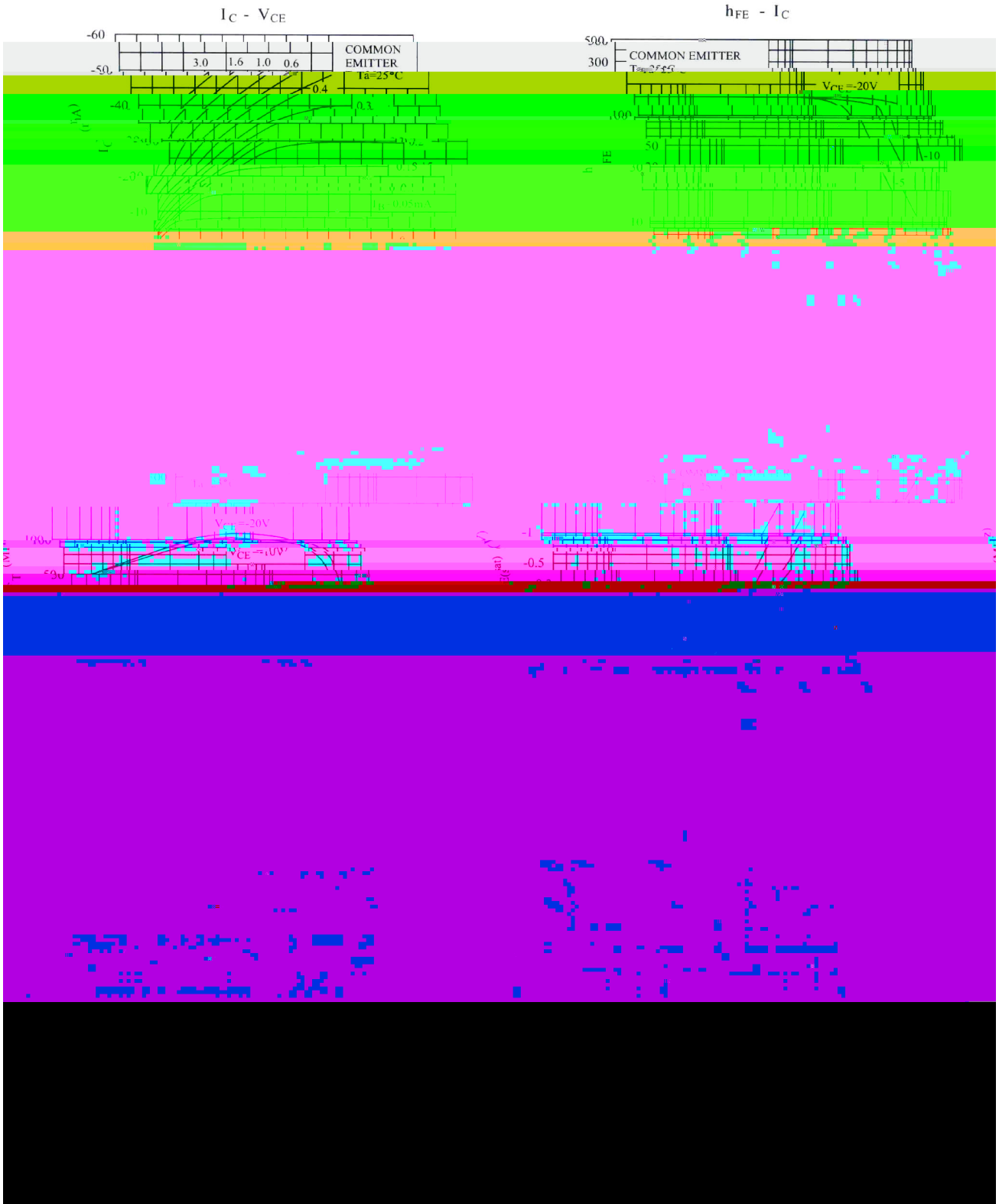

/ Package Dimensions

TO-92

Unit: mm

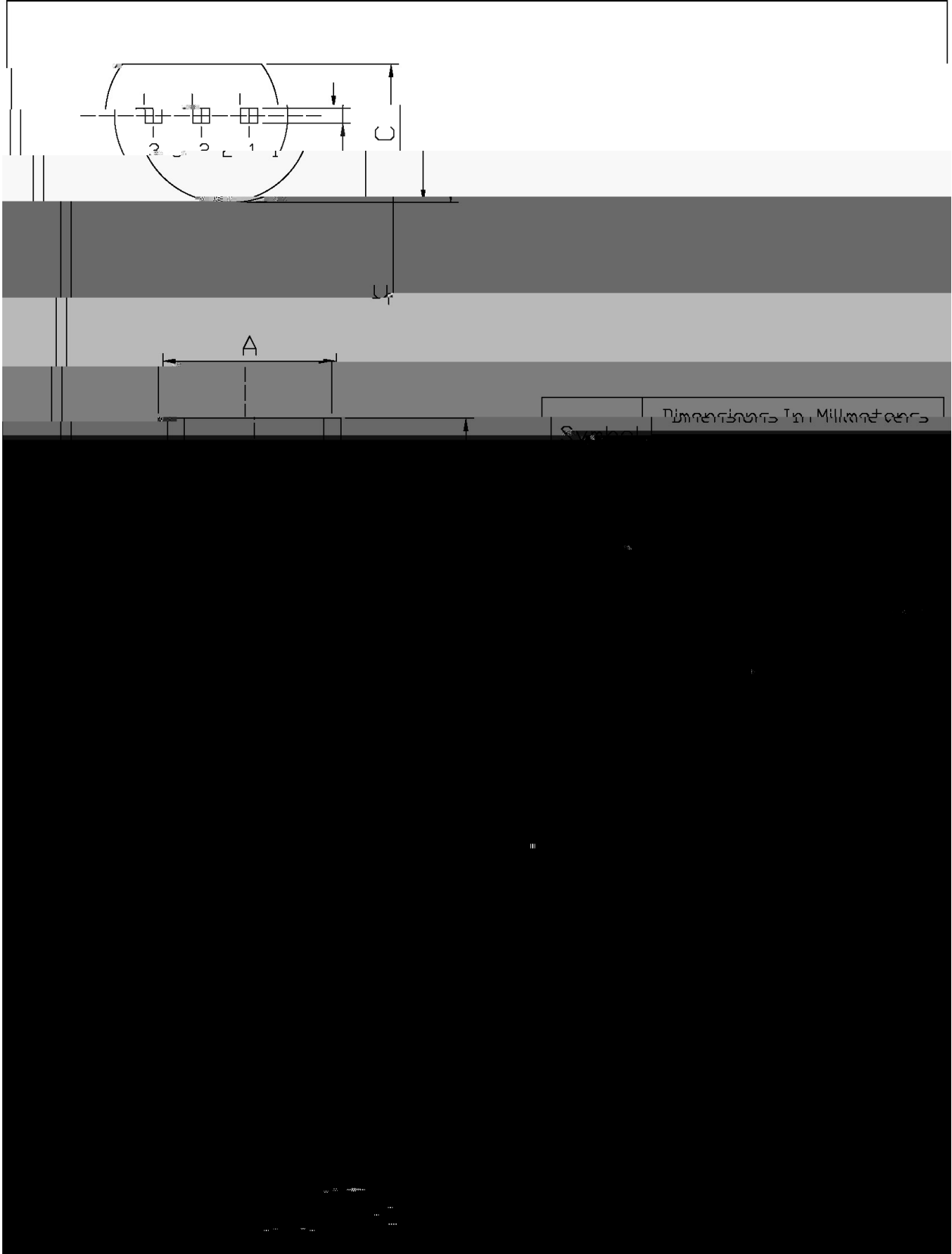

**/ Marking Instructions**

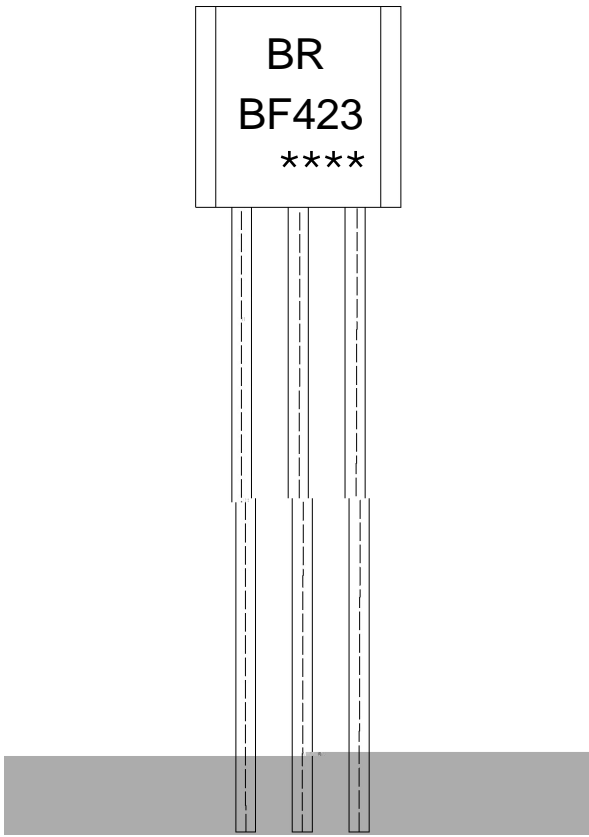

BR:

BF423

\*\*\*\*

Note:

BR:           Company Code.

BF423:       Product Type.

\*\*\*\*:         Lot No. Code,code change with Lot No.

