

Absolute Maximum Ratings(Ta=25 ;)

@ f Parameter	Symbol	f Rating	% y Unit
Drain-Source Voltage	V _{DSS}	60	V
Gate-Source Voltage	V _{GSS}	±20	V
Drain Current – Continuous	I _D	3.0	A
Pulsed Drain Current	I _{DM}	15	A
Power Dissipation	P _D	0.9	W
Storage Temperature Range	T _{stg}	-55 150	
Maximum Junction-to-Ambient	t 710s	R _{θA}	55
Maximum Junction-to-Ambient	Steady-State		139

Electrical Characteristics(Ta=25 ;)

@ f Parameter	Symbol	y i Ú ^ Test Conditions	Â 4 › Min	Á ° › Typ	Â Ý › Max	% y Unit
Drain–Source Breakdown Voltage	V _{(BR)DSS}	V _{GS} =0 I _D =250 A	60	68		V
Zero Gate Voltage Drain Current	I _{DSS}	V _{GS} =0 V _{DS} =60V			1.0	A
Gate–Body Leakage.	I _{GSS}	V _{GS} =±20V V _{DS} =0V			±100	nA
Static Drain–Source On–Resistance	R _{DS(on)1}	V _{GS} =10V I _D =3A		84	90	m
	R _{DS(on)2}	V _{GS} =4.5V I _D =3A		94	110	m
Drain–Source Diode Forward Voltage	V _{SD}	V _{GS} =0V I _D =1A		0.75	1.2	V
Gate Threshold Voltage	V _{GS(th)}	V _{DS} =V _{GS} I _D =250 A	1.0	1.8	3.0	V
Maximum Body-Diode Continuous Current	I _S				3	A
Input Capacitance	C _{iss}	V _{GS} =0V, V _{DS} =25V f=1MHz		415		pF
Output Capacitance	C _{oss}			37		
Reverse Transfer Capacitance	C _{rss}			25		
Gate resistance	R _g	V _{GS} =0V, V _{DS} =0V f=1MHz		3.4		i
Total Gate Charge	Q _{g(10V)}	V _{GS} =10V, V _{DS} =30V I _D =4.2A		10		nC
Total Gate Charge	Q _{g(4.5V)}			5		
Gate Source Charge	Q _{gs}			2		
Gate Drain Charge	Q _{gd}			3		

④ì x ? d / Electrical Characteristics(Ta=25 ;)

@ f Parameter	... Z Symbol	y ; Ú ^ Test Conditions	Â 4 › Min	Á ° › Typ	Â Ý › Max	% y Unit
Turn-On Delay Time	td(on)	VGS=10V, VDS=30V RL=7 Ÿ, RGEN=3 Ÿ		7		ns
Turn-On Rise Time	tr			12		
Turn-Off Delay Time	td(off)			16		
Turn-Off Fall Time	tf			11		

Electrical Characteristic Curve

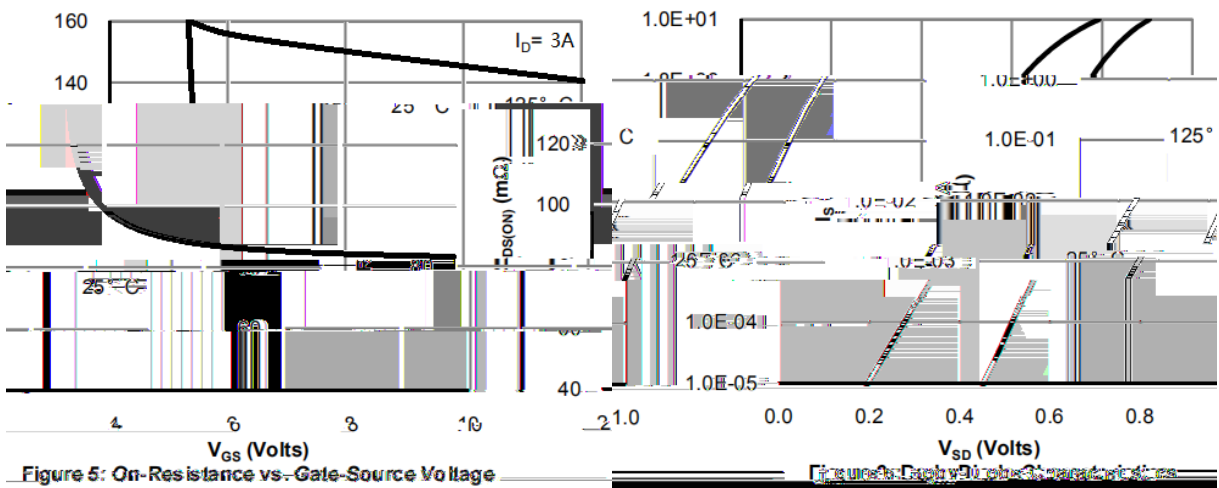
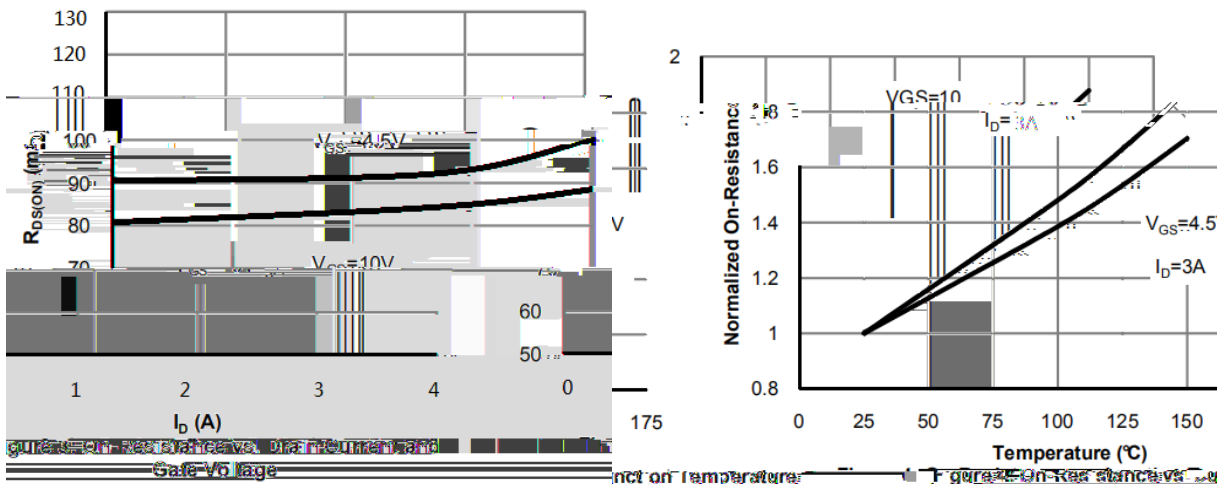
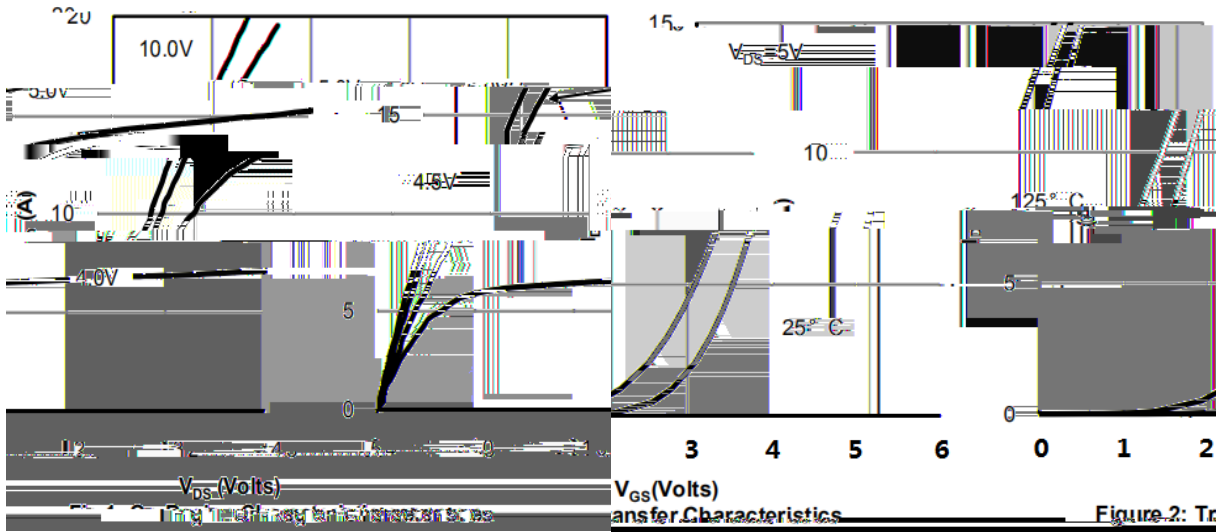

Figure 5: On-Resistance vs. Gate-Source Voltage

Figure 4: On-Resistance vs. Drain-Source Voltage

Ø □ =) φ / Package Dimensions

SOT-23

单位: mm

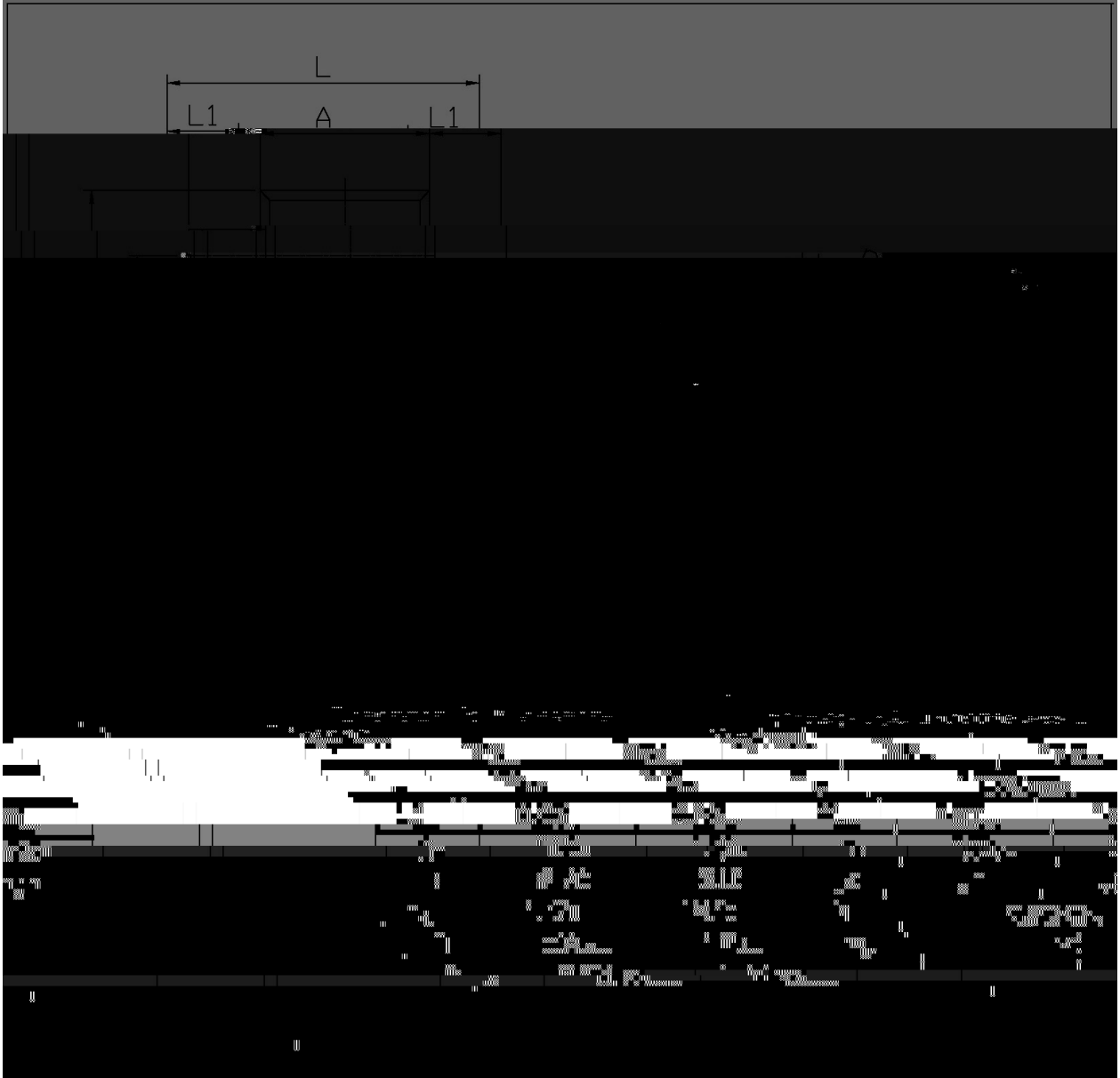

, M y f / Marking Instructions

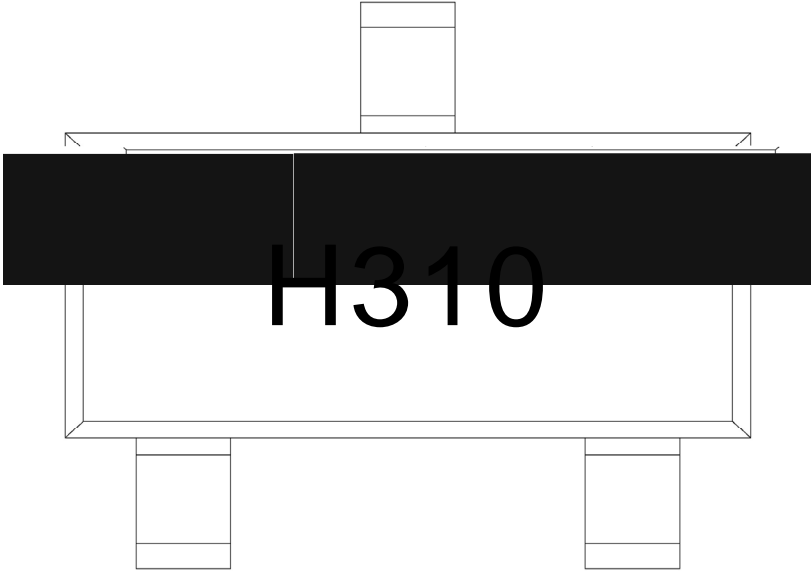

^a ϕ y

H: , [W A

310: ° Z W A

Note:

H: Company Code

310 y Product Type Code

šWD t...•Žϕ (x/) / :KSVKXGZ[XK 6XULORK LUX /8 8KLRU] 9URJKXOTM 6

^a ϕ y

- 1o• Ä ½ “ † 150 ½180 - k ž • 60 ½90sec;
- 2o• Q › “ † 245 r5 - k ž • 4 Ò 5 r0.5sec;
- 3o•D N ò i Ò 0 , † 2 ½10 - /sec.

Note:

- 1.Preheating:150~180 - , Time:60~90sec.
- 2.Peak Temp.:245 r5 - , Duration:5 r0.5sec.
- 3. Cooling Speed: 2~10 - /sec.

ÂD /Cã p ~ »] / Resistance to Soldering Heat Test Conditions

“ † y 260 r5 - ž • y 10 r1 sec. Temp.:260±5 Time:10±1 sec

G P á / Packaging SPEC.

2 & x / REEL

Package Type	Units ;>ú !H	Dimension ;>ú p . (unit Åmm ³)
7>ú ~ E		