

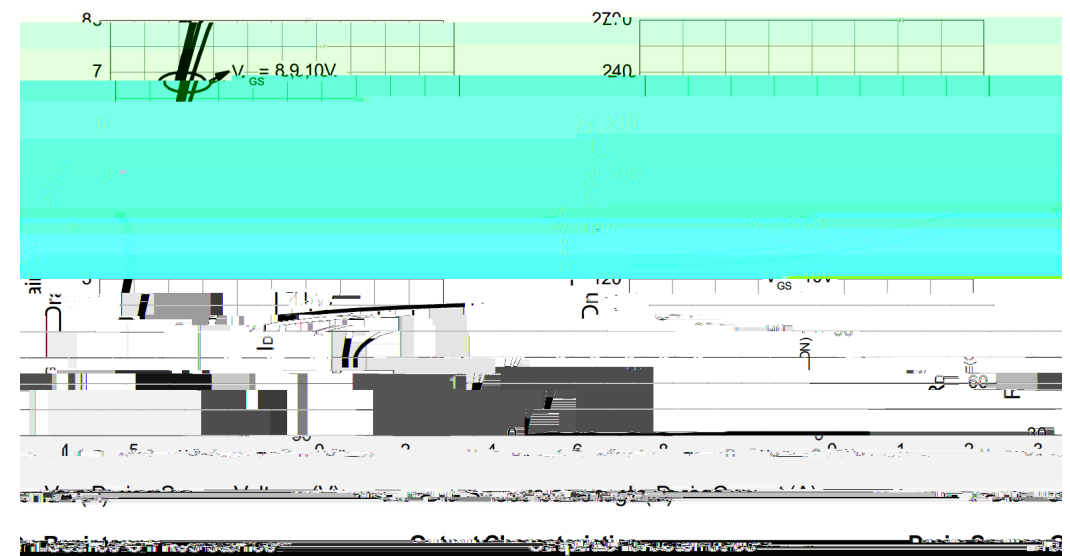

Parameter	Symbol	Rating	Unit
Drain-Source Voltage	$V_{DSS}$	100	V
Gate-Source Voltage	$V_{GSS}$	$\pm 20$	V
Maximum Drain Current - Continuous	$I_D$	5.0	A
Drain Current- Pulsed	$I_{DM}$	15	A
Power Dissipation	$P_D$	1.55	W
Maximum Junction Temperature	$T_J$	150	
Storage Temperature Range	$T_{STG}$	-55 to 150	
Maximum Resistance –Junction to Ambient	$R_{JA}$	80.7	/W

Parameter	Symbol	Test Conditions	Min	Typ	Max	Unit
Drain–Source Breakdown Voltage	$BV_{DSS}$	$V_{GS}=0V$ $I_{DS}=250\mu A$	100			V
Zero Gate Voltage Drain Current	$I_{DSS}$	$V_{DS}=100V$ $V_{GS}=0V$			1	$\mu A$

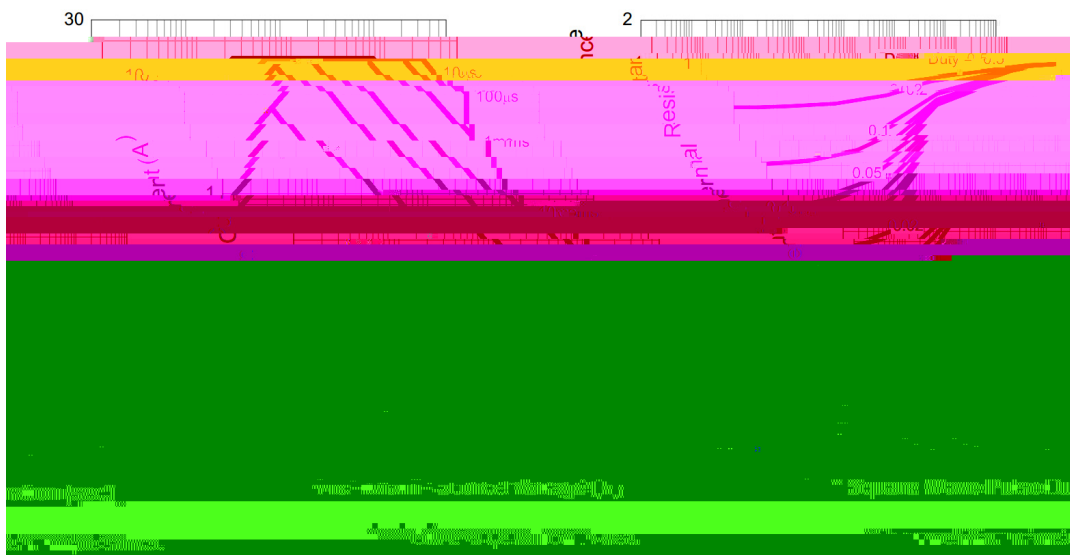

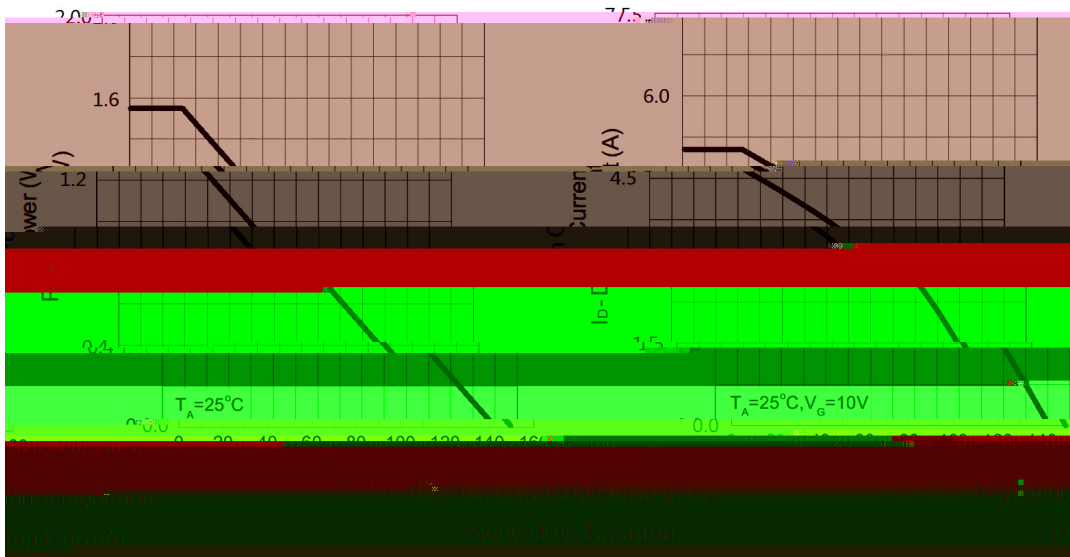

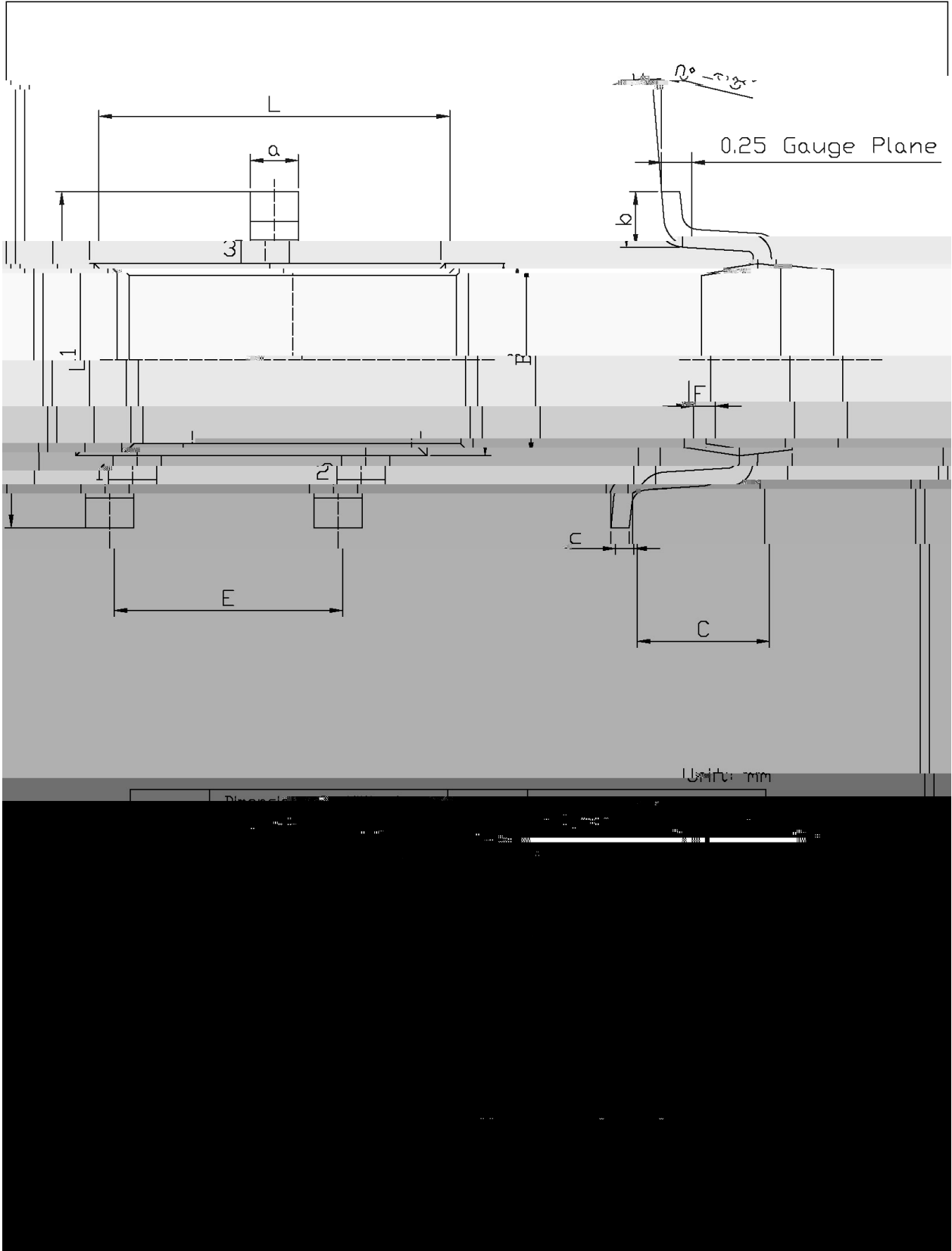

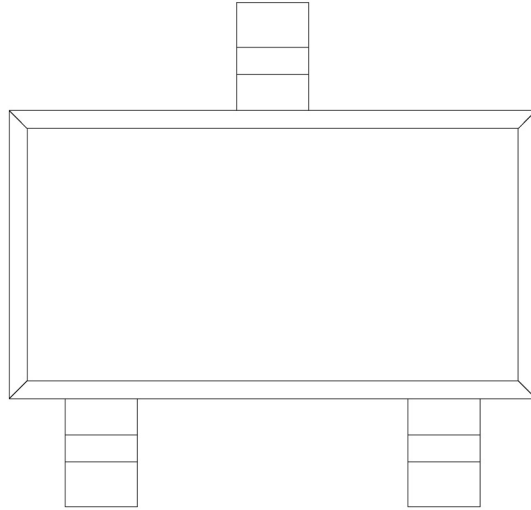

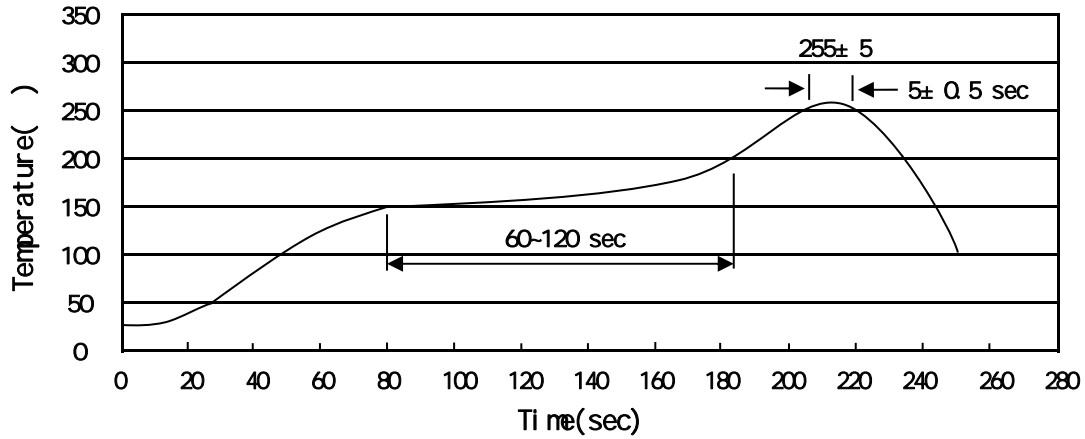
**Temperature Profile for IR Reflow Soldering(Pb-Free)**

Note:

- |   |       |     |           |         |   |
|---|-------|-----|-----------|---------|---|
| 1 | 150   | 200 | 60        | 120sec; | 1.Preheating:150~200 , Time:60~120sec.  |
| 2 | 255±5 |     | 5±0.5sec; |         | 2.Peak Temp.:255±5 , Duration:5±0.5sec. |
| 3 |       | 2   | 10        | /sec.   | 3.Cooling Speed: 2~10 /sec.             |

260±5

10±1 sec.

Temp.:260±5

Time:10±1 sec

/ REEL

Package Type	Units					Dimension (unit mm <sup>3</sup> )		
	Units/Reel	Reels/Inner Box	Units/Inner Box	Inner Boxes/Outer Box	Units/Outer Box	Reel	Inner Box	Outer Box
SOT23-3	3,000	10	30,000	4	120,000	7 x8	210x205x205	445x435x230