

/ Descriptions

TO-220F N MOS N-CHANNEL MOSFET in a TO-220F Plastic Package.

/ Features

Low gate charge, low crss, fast switching.

/ Applications

DC/DC

These devices are well suited for high efficiency switching DC/DC converters and switch mode power supplies.

/ Equivalent Circuit

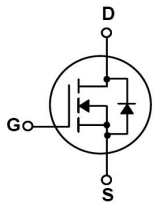

/ Pinning

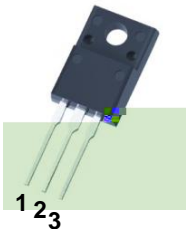

PIN1 G PIN 2 D PIN 3 S

/ h_{FE} Classifications & Marking

See Marking Instructions.

Parameter	Symbol	Rating	Unit
Drain-Source Voltage	V_{DS}	500	V
Drain Current	$I_D(T_C=25^\circ\text{C})$	5.0	A
Drain Current	$I_D(T_C=100^\circ\text{C})$	3.0	A
Drain Current - Pulsed	I_{DM}	20	A

Gate-Source Voltage

Yes
Source $V_{GS} = 5.0 \pm 0.3 \text{ V}$

/ Electrical Characteristic Curve

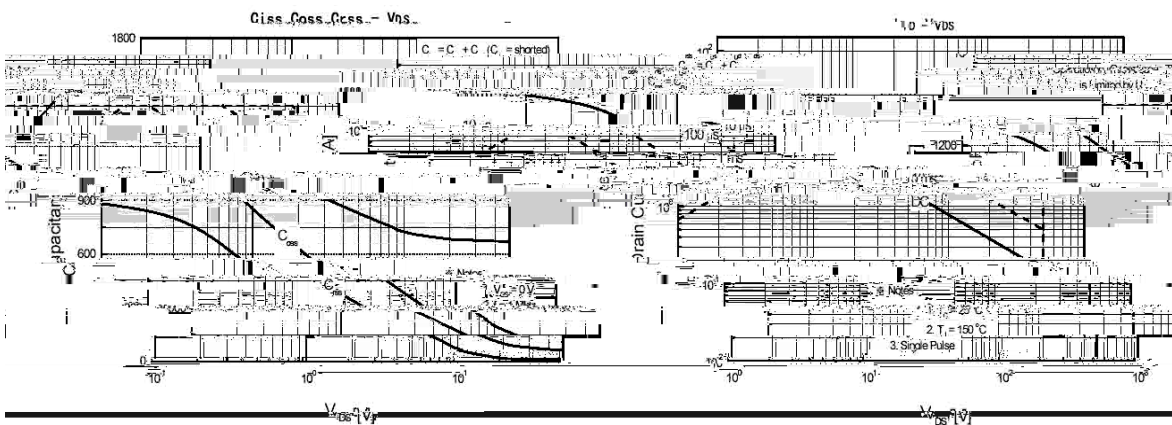
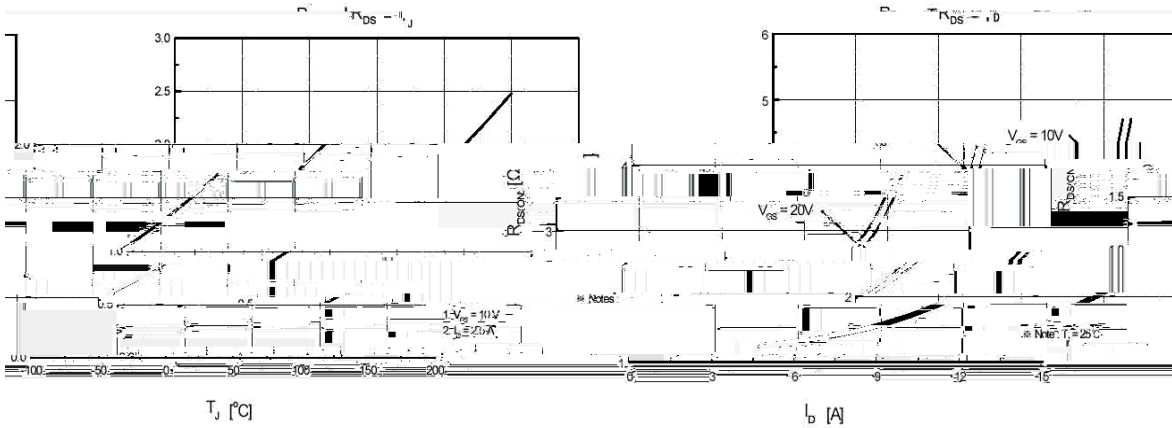
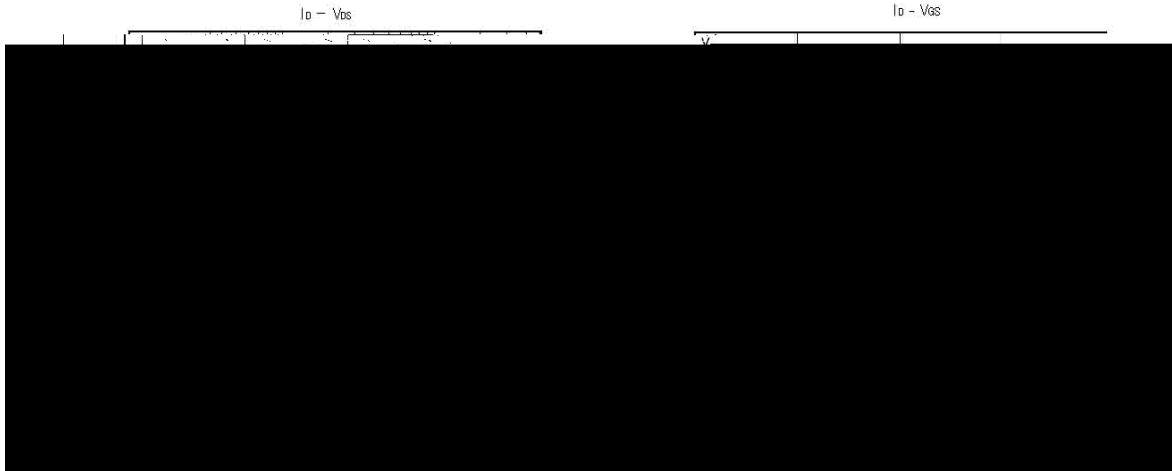

/ Package Dimensions

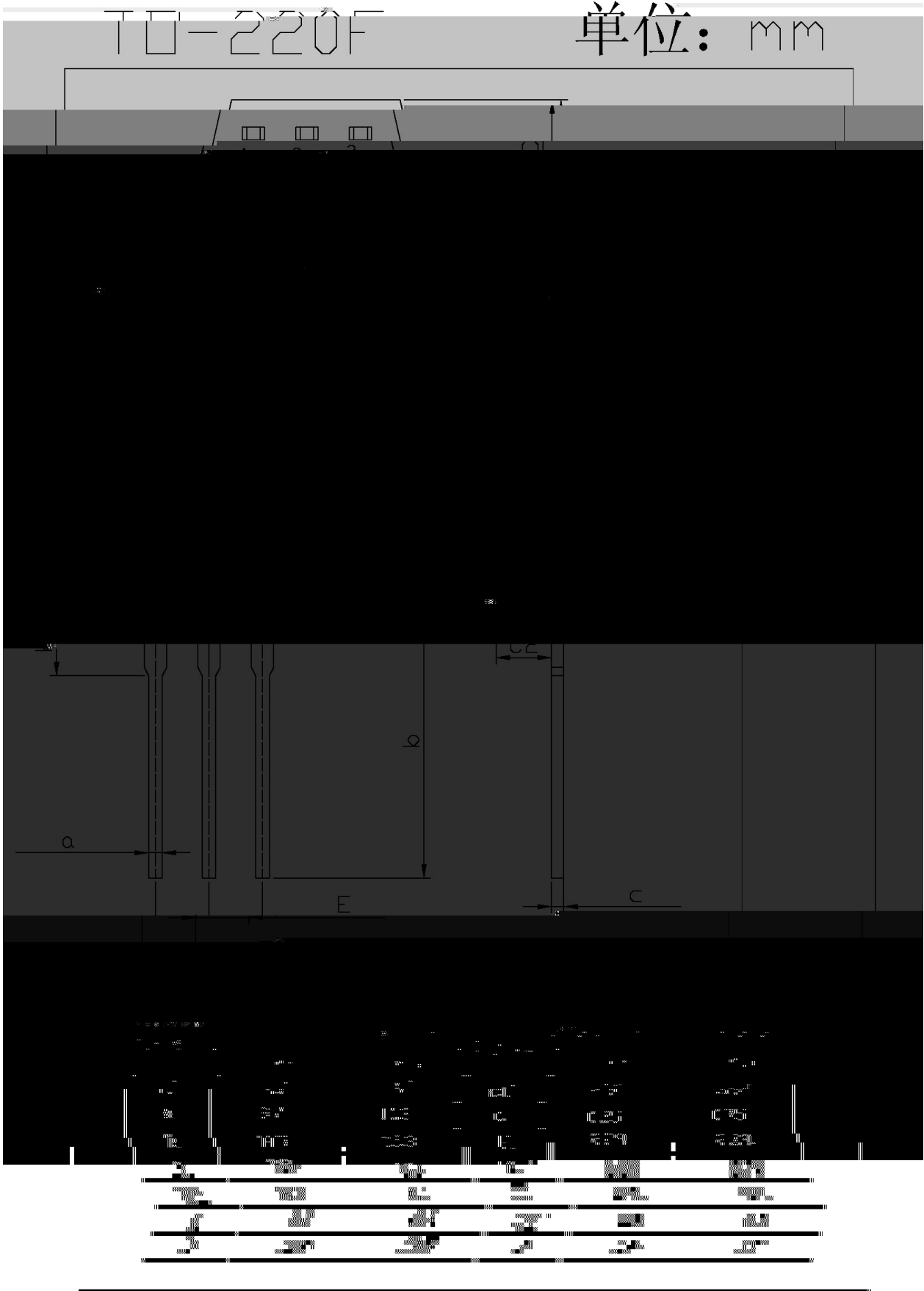

/ Marking Instructions

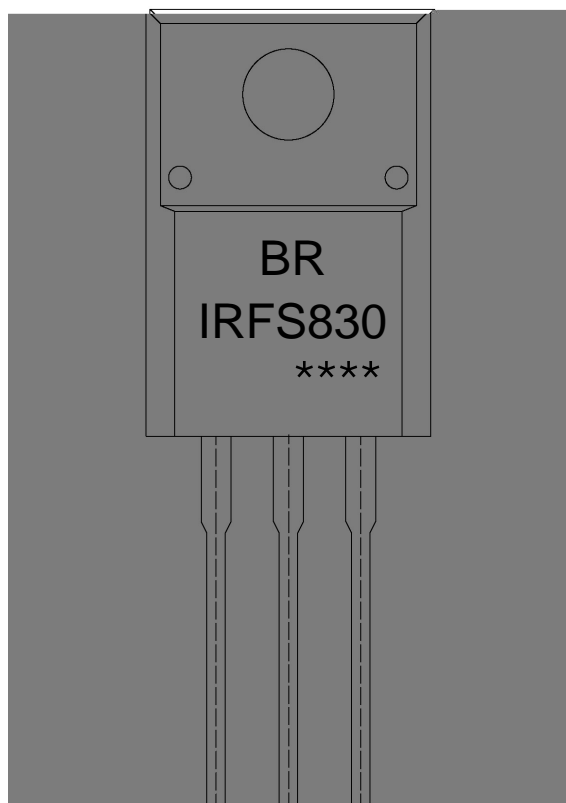

BR

IRFS830

Note:

BR: Company Code

IRFS830: Product Type.

****: Lot No. Code, code change with Lot No.

