

/ Descriptions

/ Features

/ Applications

/ Equivalent Circuit

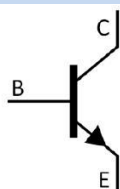

/ Pinning



/  $h_{FE}$  Classifications & Marking



peratCurggrge

/ Electrical Characteristic Curve

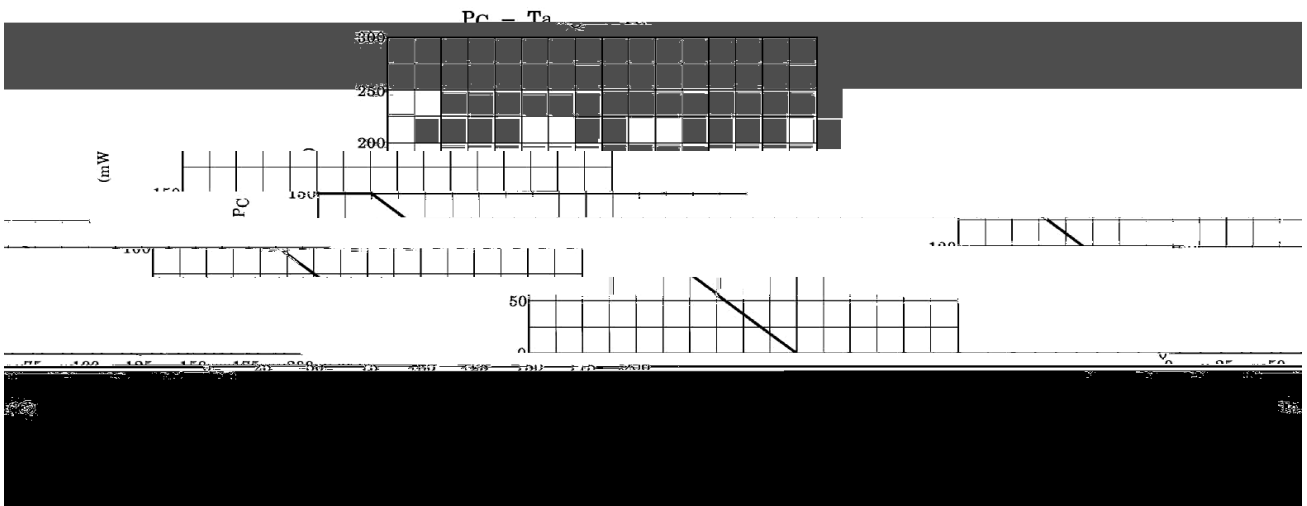
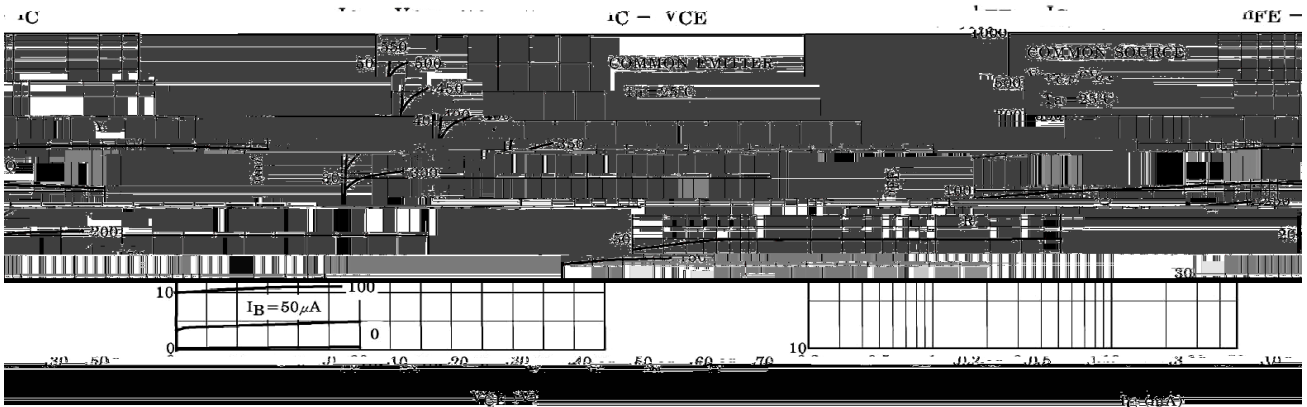

/ Package Dimensions

SOT-23

单位: mm

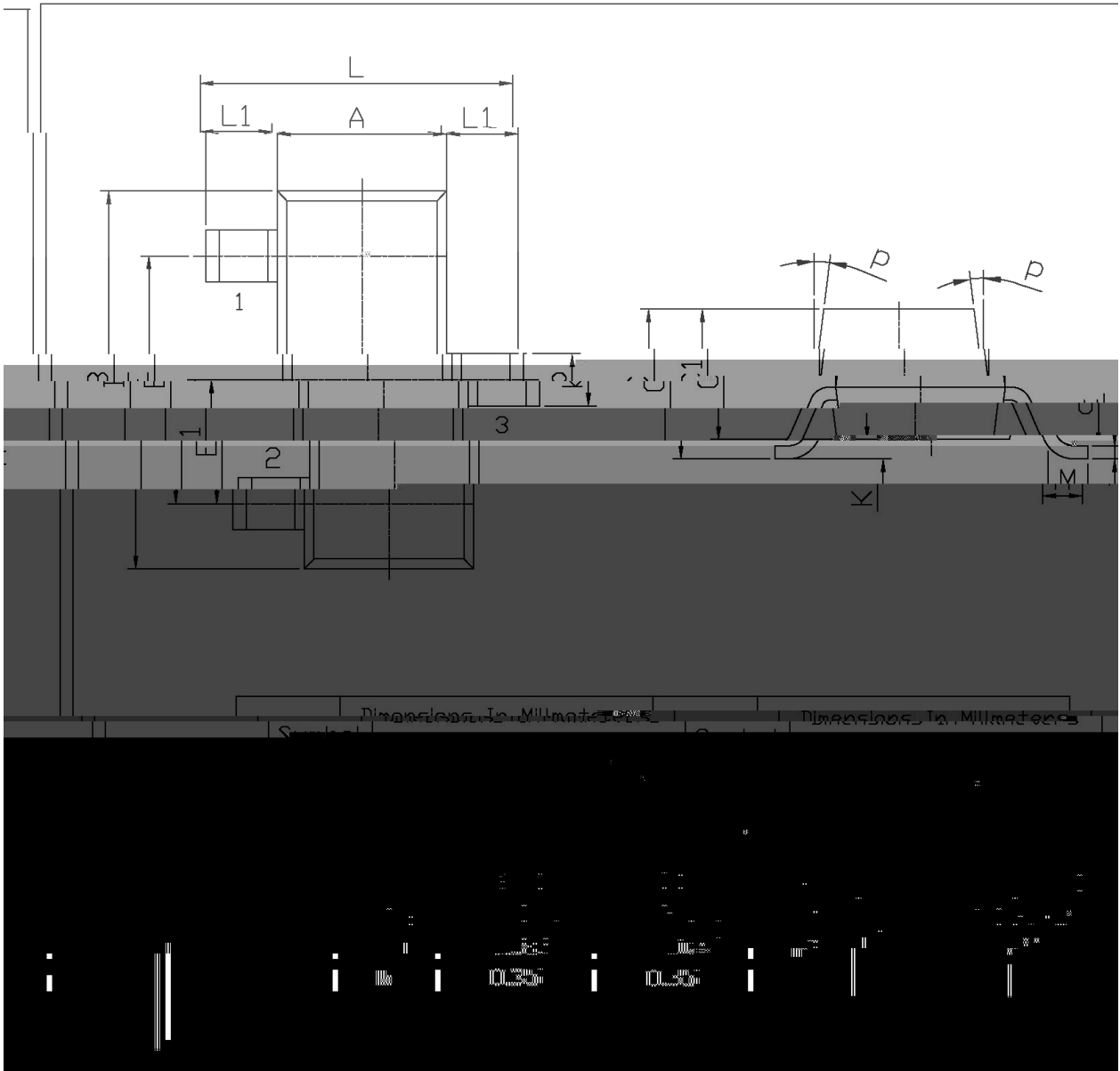

/ Marking Instructions

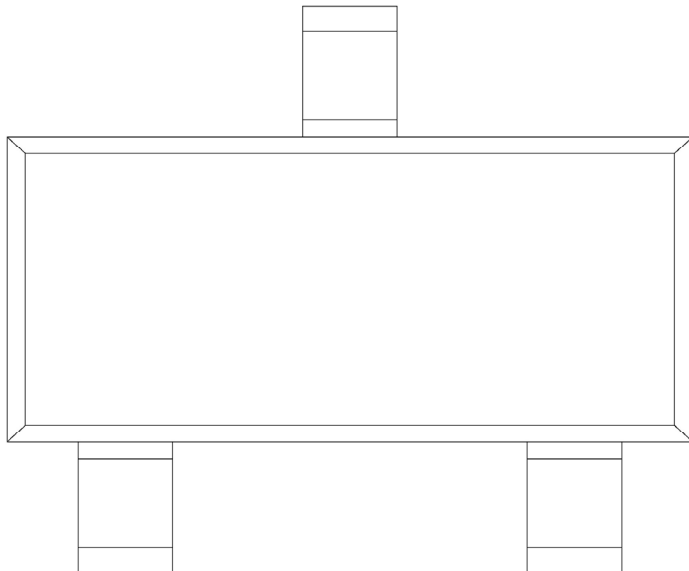

( ) / Temperature Profile for IR Reflow Soldering(Pb-Free)

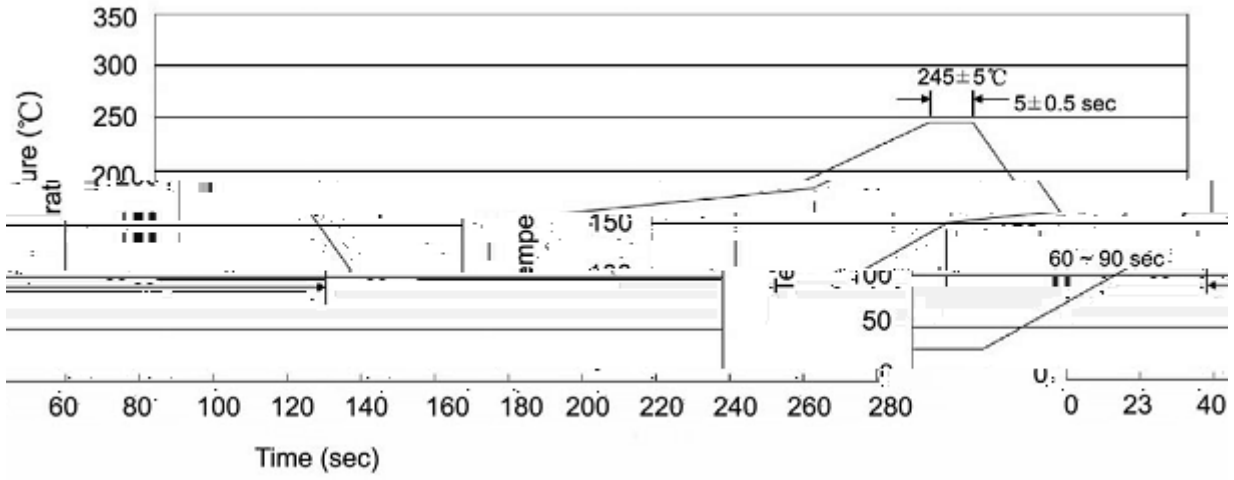

/ Resistance to Soldering Heat Test Conditions

/ Packaging SPEC.
