

LV20100DCT

Rev.G Mar.-2020

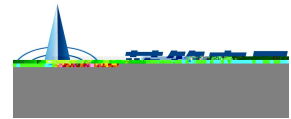

DATA SHEET

/ Descriptions

TO-252

Schottky Diode in a TO-252 Plastic Package.

/ Features

Low forward voltage drop, low power losses, High efficiency operation. HF product.

/ Applications

OR-ing DC-DC

For use in high frequency inverters, switching power supplies, freewheeling diodes, OR-ing diode, dc-to-dc converters and reverse battery protection.

/ Equivalent Circuit

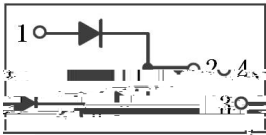

/ Pinning

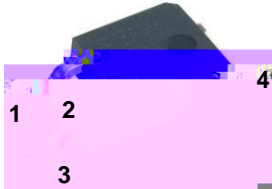

PIN1 Anode PIN 2 4 Cathode PIN 3 Anode

/ h_{FE} Classifications & Marking

See Marking Instructions.

/ Electrical Characteristic Curve

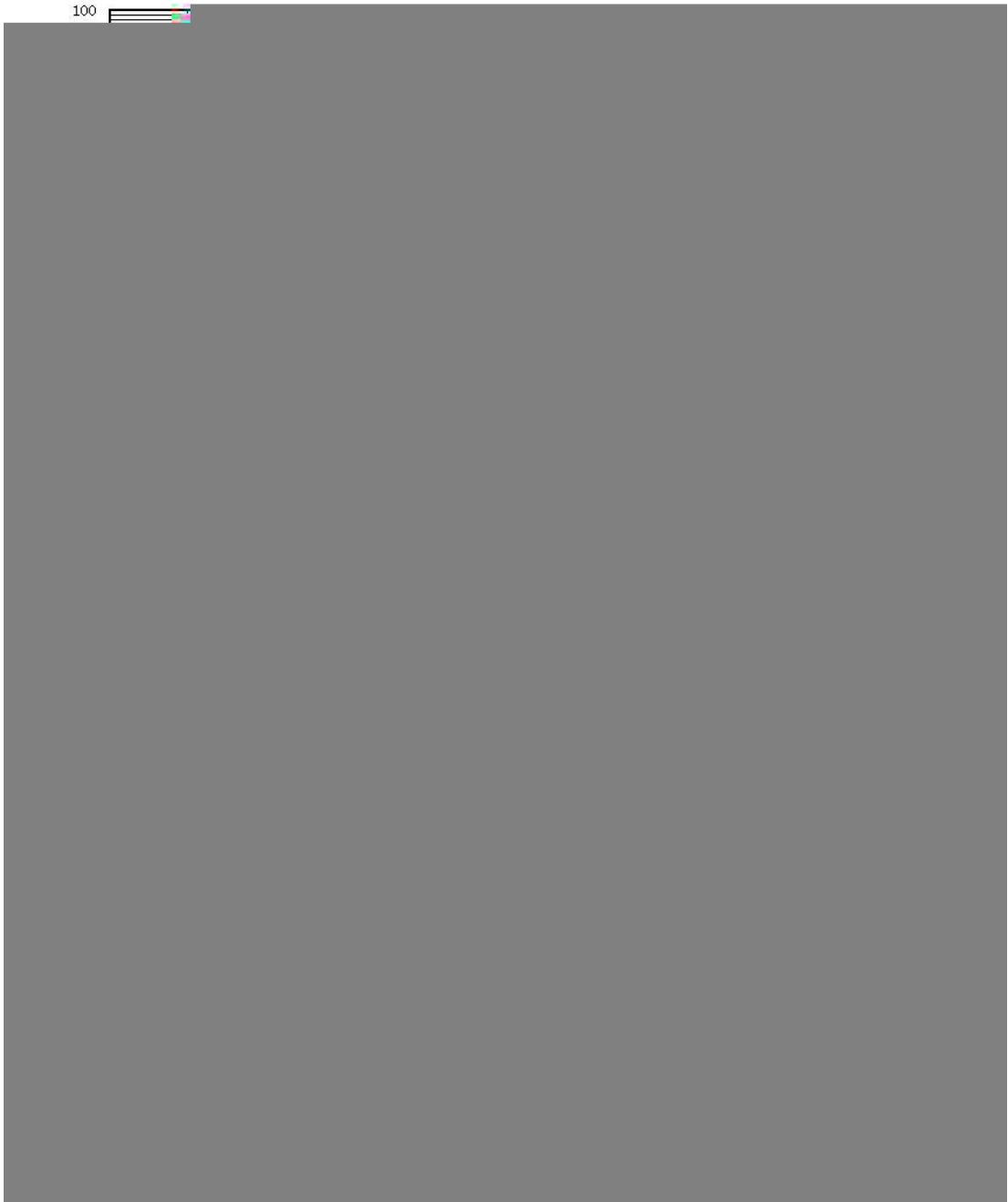

/ Package Dimensions

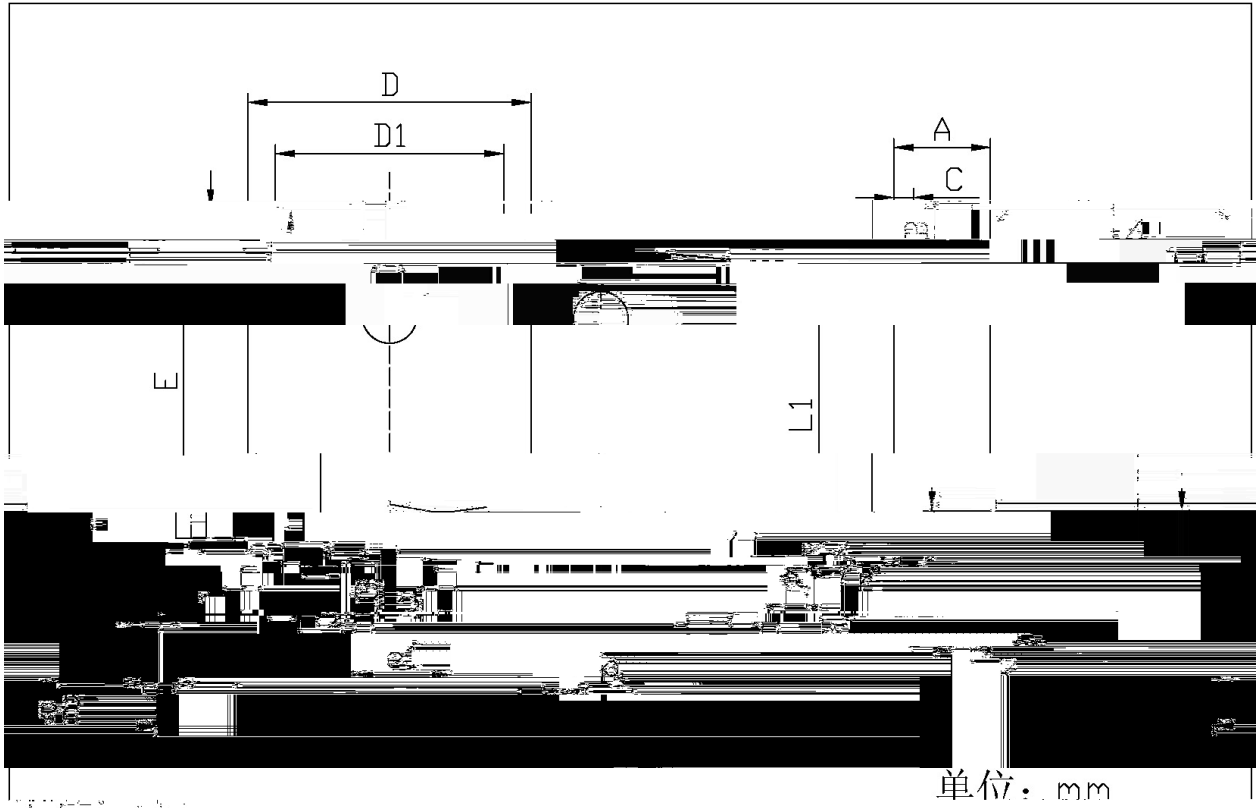

Symbol		Symbol		Symbol	
Min	Max	Min	Max	Min	Max
0.50	0.70	2.20	4.48	4.73	b
0.45	0.55	1.00	9.45	9.95	b1
1.25	1.75	C	0.45	0.55	L2
0.60	0.60	D	6.45	6.75	L3

LV20100DCT

Rev.G Mar.-2020

DATA SHED D D D)

6

r (